



**PONDICHERY UNIVERSITY
PURCHASE AND STORES**

Dr. S. Balakrishnan
Professor & Head

Department of Earth Science
Pondicherry University

Ref.: No.PU/ES/52/2012-13/

Date: 26.2.2013

Tender Notification

**Sub: Pondicherry University – Purchase & Installation of
Auditorium Furnitures for Department of Earth Science - Sealed
Quotations – Reg.**

-000-

Sealed Quotations are invited under **Two Bid Systems** for supply and installation of furnitures in Department of Earth Science, as per the Specifications given below with the following terms and conditions.

Name of the Work	Required quantity	Cost Per unit
1) Auditorium Chair for Seminar Hall located in Second floor of Department of Earth Sciences (Diagram of Seminar hall, Model & Specification of chair are Enclosed)	200 Nos. Approximate	

Terms and Conditions:

- 1) The technical details and specification should be given in a separate cover superscribing **“Technical Bid for Supply of Auditorium furniture”** for Department of Earth Science.
- 2) A separate cover should be submitted for Price Bid by quoting unit wise price as well as total price. The rates should be inclusive of all taxes, octroi, Insurance, Packing , forwarding, transit, installation, fixing etc and initial preparatory work (if any) .
- 3) Quotation must be valid for one year
- 4) The Purchase Committee will strictly evaluate the durability, reputation of the firm, their past performance etc., for which the complete details should be submitted in the technical bid
- 5) The University has the right to select or reject any quotation partly or fully without assigning any reason thereof.
- 6) The rate quoted shall on FOR destination basis at our premises.
- 7) Delivery is to made within 30 days from the date of receipt of supply order.
- 8) Payment will be made after the successful supply and after getting a Certification of Quality of the entire consignment by the Quality Inspection Committee.

.....2

- 9) The quotations should reach the above said address **on or before 4.00 P.M on 18th March 2013**, These will be opened at 4.30 P.M in the same day, in presence of the Tenderers, if an available.
- 10) The proof of following documents should be enclosed.
 - a. Copy of Registration Certificate
 - b. Copy of PGST/CST registration
 - c. PAN allotted by Income Tax Department
- 11) An amount of **Rs.10,000/-** should be remitted as EMD in the form of Demand Draft from any one of the nationalized banks, drawn in favour of The Finance Officer, Pondicherry University, payable at Pondicherry.
- 12) The bids without the E.M.D. will be summarily rejected.
- 13) Only manufacturers or exclusive authorized dealers/resellers of such products are permitted to quote against the requirements.
- 14) The firm should have been in **existence for at least three years** (proof to be attached) and should have supplied similar furniture for large organization.
- 15) If an order is placed with the firm, the purchase shall be governed by an agreement as per the University rules in force at this time.
- 16) No unsolicited correspondence shall be entertained after the submission of the offer.
- 17) Warranty details should be clearly specified. The materials covered under the purchase order, when installed, shall be warranted for the quality, workmanship, trouble free operation and performance for a period of at least 24 months from the date of delivery or 30 months from the date of receipt of the last material of the consignment.
- 18) The firm should also submit the proof for execution of similar type of work namely supply of Wooden, Modular Furniture to the Educational Institutions, Government / Public Sector organizations / R & D organizations / National laboratories for total worth of Rs.50 Lakhs and more during the past 3 years.
- 19) The Original manufacturer of the modular furniture who had already supplied similar kinds of auditorium chairs for the Institutes of Higher Education are also free to quote with any other model of their own product with closely matching the specification or considered to be parallel or better models and products of the notified items this tender.
- 20) The best sample of the firms has to be submitted along with quotation.
- 21) The final selection will be made based on the acceptance of the sample/model approved by the University and not on the basis of L-1 rates only.

HEAD OF THE DEPARTMENT

Diagram of Auditorium :

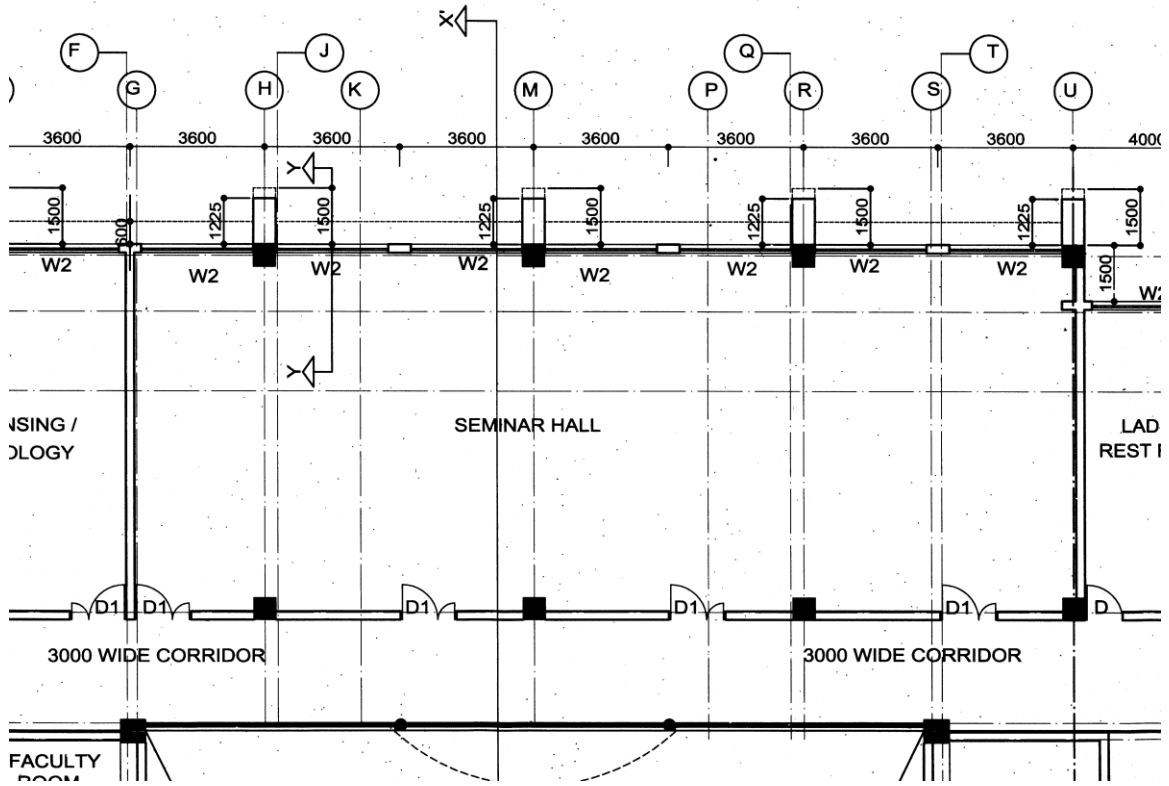

Location: Second Floor, Department of Earth Sciences, Pondicherry University

Model & Specification of Auditorium Chairs

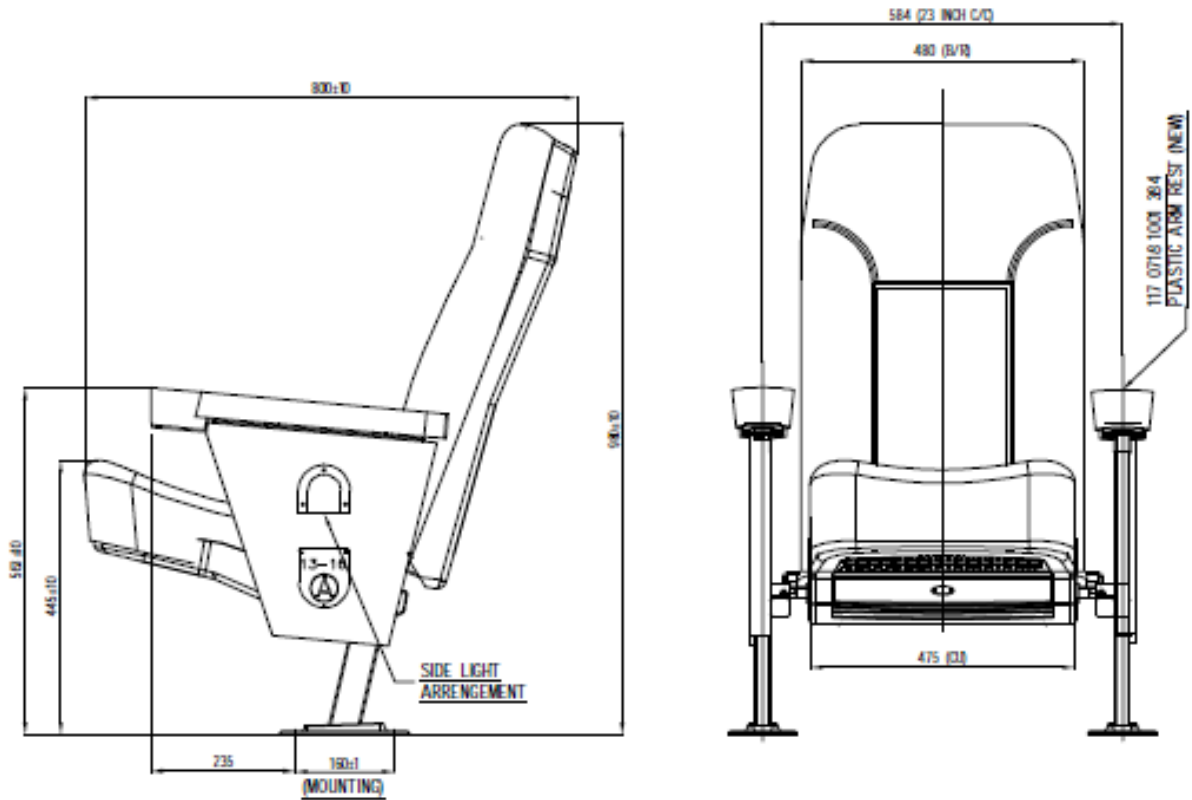

Product Specification -

Understructure:-

The base is to be made up of sturdy MS Powder coated frame. The frame has a Flange plate below for the grouting of the seat to the floor. The footprint area for the base plate is 160mm. For better finish zinc passivated Anchor – fasteners with high bonding grouting material has been used. The Base plate has a groove of 12mm for screwing it to the floor. Grouting - 2 nos of 75mm (for hard floor). Leg : sq TUBE IS:4923-1997- 25X25 mm , 1.63 Thickness.

Back and Seat Assembly: -

This is a fixed back chair with its back rest frame made of ERW tube/ IS:3074-2005 Grade 1-16 dia round pipe 1.2mm thickness & extra reinforcement 16 dia round pipe 1.2mm. The cushion frame / seat is to be made of ERW tube /IS:3074-2005 Grade 1-19 dia round pipe of 1.2mm thickness. The back and seat housing comprises of high performance (PPCP IS: 10915 1994) injection moulded Thermoform Plastic. The seat and back details are as follows:-

- Seat depth from the end of back :- 800 (+/- 10)mm
- Back height :- 980 (+/- 10)mm
- Seat Height:- 445 (+/- 10)mm
- Centre to centre Chair width :- 584mm
- Back rest width – 480mm (B/R)
- Seat width – 475mm (CU)
- Arm rest Height – 563 (+/- 10)mm
- Minimum Row spacing :- 950mm
- Recommended Row spacing :- 1000mm

Foam: -

The back and seat are to be made of High Resilience automotive polyurethane grade foam. The density of the foam is 50 (+/- 5) Kg / cu/ JIS K 6401. Meter. Constant Compression Set: (Max. 13%) JIS K 6401.

Upholstery: -

Premium foam back fabric should be used for upholstery on the back and seat. The upholstery of high quality provides durability to the foam and also adds to the rich look and feel to the complete chair. The fabric used must have high abrasion resistance and heavy duty, 100 % polyester dyed yarn with 3mm + .5mm foam backing. The fabric must be certified flammability as per the following standards:-

- BS EN 1021- 1 : 1994 (Cigarette)
- BS EN 1021- 1 : 1994 (Low Hazards)

Armrest: -

The armrest understructure must be aesthetically designed, sleek and profiled wing frame made of 'V' frame and the side wing frames are to be made of upholstered plywood. The armrest width 80mm and offered as common armrest between chairs, with polished solid wood arm rest (without cup holder)